

WASHING AND DRYING SOLUTION - TDM SERIES

TANDEM TDM 11/11 - 18/18 KG

Washer and Tumble dryer up to 18 Kg capacity in less than 1m²

WASHING MACHINE

IM11 - advanced UX and UI
Wi-fi control of the washing cycles through IM11, I'M CONNECT portal and App.

Standard equipment
3 detergent dosing pumps of 30 l/h.

Reliability and maneuverability (TDM 18)
Mechanical door lock system and conical door gasket.

AISI 304 stainless steel structure
STAINLESS STEEL front, sides, top, drum, spider and outer drum.

TUMBLE DRYER

Multifunction
Cooling function, anti-wrinkle fuction, suction speed control.

AISI 304 stainless steel drum
Without sharp edges for better conservation of linen.

IM10: intuitive for easy interaction
Drying parameters can be modified after the cycle is started.

Easily removable filter
Easy to clean filter with cleaning signaling on the display.



SCAN FOR MORE INFO



SCAN FOR MORE INFO

OPTIONS and ACCESSORIES

- Payment systems for self-service use

HIGH SPIN WASHING MACHINE

- 1 or 2 x 30lt/h pump including flush + lance + tank end signal (3 standard)
- Drain pump kit
- VHard water inlet valve
- Second exhaust valve

TUMBLE DRYER

- Working at partial or full power (only electric)
- Left-hand door opening
- Stainless steel steam exchanger filter

TECHNICAL DATA	TDM 1111	TDM 1818
- Washing machine capacity 1:9 - 1:10	12 - 11 Kg (26 - 24 lb)	20 - 18 Kg (44 - 40 lb)
- Washing machine drum diameter Ø	535 mm (21 inch.)	700 mm (27.6 inch.)
- Washing machine drum depth	470 mm (18.5 inch.)	470 mm (18.5 inch.)
- Washing machine load diameter Ø	282 mm (11.1 inch.)	380 mm (14.9 inch.)
- Washing machine spin speed	1002 r.p.m.	947 r.p.m.
- Washing machine G factor	300	350
- Cold water consumption*	68 lt (2.4 ft³)	119 lt (4.2 ft³)
- Hot water consumption*	20 lt (0.7 ft³)	34 lt (1.2 ft³)
- Water consumption*	88 lt (3.1 ft³)	153 lt (5.4 ft³)
- Washing machine drain flow	160 lt/min (5.6 ft³/min)	160 lt/min (5.6 ft³/min)
- Dryer capacity 1:18 - 1:20	12 - 11 Kg (26 - 24 lb)	20 - 18 Kg (44 - 40 lb)
- Dryer drum diameter Ø	700 mm (27.6 inch.)	756 mm (29.8 inch.)
- Dryer drum depth	560 mm (22 inch.)	797 mm (31.4 inch.)
- Dryer load dimension Ø	560 mm (22 inch.)	560 mm (22 inch.)
- Dryer air flow	450 m³/h	1120 m³/h
- Max counterpressure	10 mt	10 mt
- Air sound intensity	65 dB (A)	70 dB (A)
- Heating leakage	5 %	5 %
- Vent air\smokes Ø	100 mm (3.9 inch.)	150 mm (5.9 inch.)
- Machine dimension WxDxH (100 mm = 3.93 inch.)	720x1003x1991 mm	880x1196x2159 mm
- Net weight (electrical + electrical)	397 Kg (875 lb)	630 Kg (1389 lb)
- Packing dimension WxDxH (100 mm = 3.93 inch.)	760x1045x2111 mm	1000x1196x2280 mm
- Gross weight (electrical + electrical)	404 Kg (890 lb)	645 Kg (1422 lb)
- Packaging volume	1.7 m³ (60 ft³)	2.7 m³ (95 ft³)
- STD. packed machines in to 20' container	16 pz.	11 pz.
- STD. packed machines in to 40' container	34 pz.	26 pz.

DATA BY TYPE OF HEATING

- Electrical Heating (washing machine - dryer)	23 kW (9 - 14 kW)	30 kW (12 - 18 kW)
- Electric consumption* (washing machine - dryer)	8,9 kWh (1,4 - 7,5 kWh)	14,6 kWh (2,6 - 12 kWh)
- Electric absorption (washing machine - dryer)	25 kW (10,5 - 14,5 kW)	33,2 kW (14,5 - 18,7 kW)
- 3ph380V-480V(+N) / 3ph220-240V / 1ph230V 50\60 Hz	34 / 59 / 102 A	49 / 84 / - A
- Steam heating consumption* (washing machine - dryer) (0,3-1=4,5-15 bar)**	24,03 Kg (0,3 - 24 Kg)	39,6 Kg (0,6 - 39 Kg)
- Steam\HW or GAS heating consumption* (Wash. - Dry.)	2 kW (1,5 - 0,5 kW)	3,3 kW (2,5 - 0,8 kW)
- Steam\HW or GAS consumption* (washing machine - dryer)	1,1 kWh (0,8 - 0,3 kWh)	1,8 kWh (1,4 - 0,4 kWh)
- Steam\HW or GAS heating 3ph380V-480V(+N) / 3ph220-240V / 1ph230V 50\60 Hz	5 / 6,5 / 9 A	8 / 13,5 / 15 A

*Cycle "COTTON" 60°C, EN60456, tab. A2: wash 60°C (15') and 4 cold rinses (3'+3'+2'+2'), motor rhythm 12"/3"/12"; middle spins and 5' final spin: cotton 180 gr/m². Cold water 15°C, hot water supply 60°C. ** Available option: 9,5 bar (min 1 bar)

*** Dryer standard cycle: load at nominal value of cotton (180gr/m²) wet with residual humidity of 50% and brought to 0%; 3' cool down.

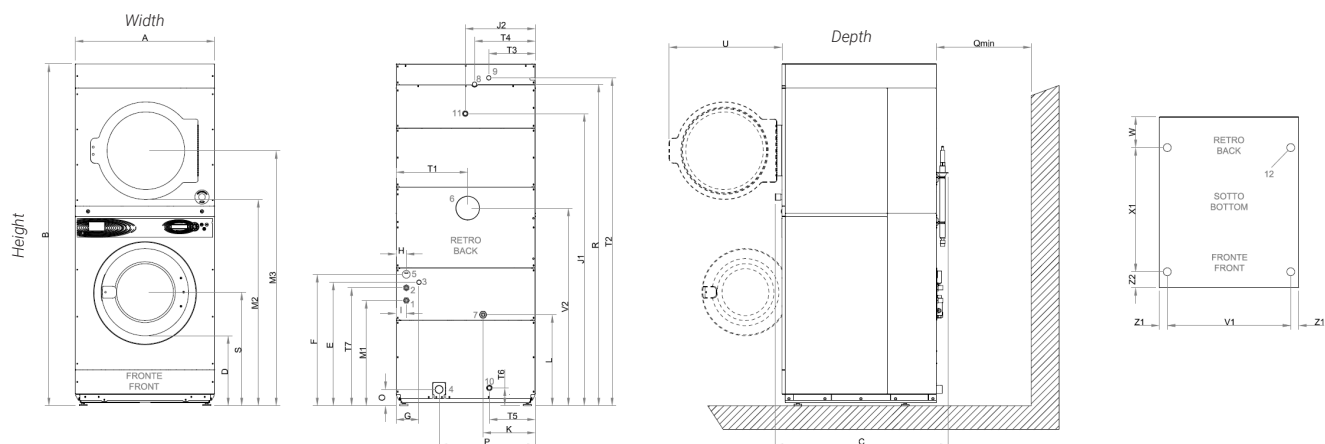

Pos. 1 - Washing machine cold water Ø ¾"; Pos. 2 - Washing machine hot water Ø ¾"; Pos. 3 - Washing machine direct steam (only steam heated machine); Pos. 4 - Washing machine water drain Ø 50 mm; Pos. 5 - Washing machine Ø 50 mm; Pos. 6 - Humid air and smoke exit (Dryer) TDM 1111 Ø 100 mm, TDM 1818 Ø 150 mm; Pos. 7 - Electrical power supply; Pos. 8 - Dryer input steam (only steam heated machine) Ø ¾" - 1"; Pos. 9 - Dryer input steam (only steam heated machine) Ø ¾" - 1"; Pos. 10 - Washing machine steam drain (only direct steam heated machine); Pos. 11 - GAS supply (only GAS heated dryers) Ø ¾"; Pos. 12 - 4 "M10" feet - 100 mm = 3.93 inch. - factor conversion 1 / 25,4

[mm]	A	B	C	D	E	F	G	H	I	J ₁	J ₂	K	L	M ₁	M ₂	M ₃	O	P	Q _{min}	R	S	T ₁	T ₂	T ₃	T ₄	T ₅	T ₆	T ₇	U	V ₁	V ₂	W	X ₁	Z ₁	Z ₂
TDM 1111	720	1991	1003	361	534	961	45	60	45	1675	645	220	876	766	1172	1483	103	560	600	1881	583	460	1923	121	211	461	134	846	715	640	1132	27	795	40	59
TDM 1818	720	1991	1003	443	753	830	145	65	65	1841	76	330	575	665	1303	1611	103	608	600	2031	718	142	2071	294	384	140	111	745	715	780	1248	195	784	50	100